



IC983V-SN



IC983V-BN



IC983H-SN



IC983H-BN

Introduction

- Built-in rechargeable button battery
- Choice of Public or Private operating modes
- Backlit keypad for easy visibility
- LED indicator shows locked status
- Alarm sounds for incorrect password entries
- Durable zinc alloy construction
- Compatible with both metal and wooden cabinets

Technical Parameter

- Power Supply: CR1220/CR1225 lithium batteries
- Battery Life: 2+ years (20-50 uses/day)
- Voltage: DC 2.3V-3.3V
- Current Static $\leq 20\mu A$, Dynamic $\leq 200mA$
- Operating Range : $-15^{\circ}C$ to $+55^{\circ}C$, 20-95% RH
- Safety Low battery warning system
- Door Thickness Metal: 0.5-12mm, Wood: 16-22mm

Measurement

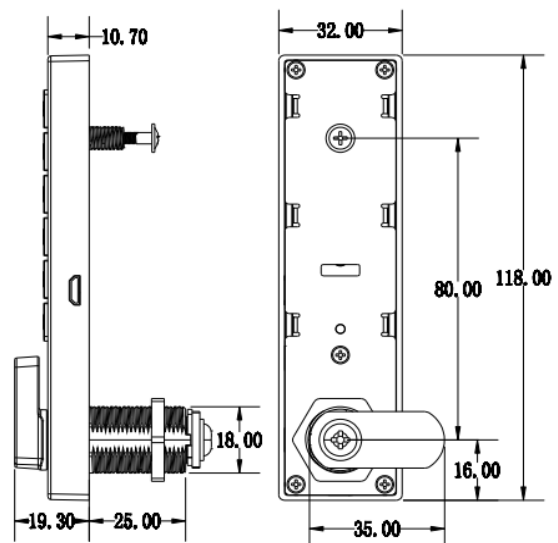

| Part | Name | Application |
|------|--------------------------------|--|
| | Flat | For single door of cabinet |
| | Hook | |
| | Offset | |
| | Heptagon | For double door of cabinet |
| | Rod connector | For metal file cabinet |
| | 3 x AAA alkaline batteries | Better for Public use (or Private use) For wooden door |
| | Lithium battery (Rechargeable) | Suitable for Private use For wooden or metal door |