

Model DS606

Optical Sliding Turnstile

DS606 is made of 304 full stainless steel, stable and firm. The glass arm can be extended to 1000mm and operate smoothly. The top is equipped with LED indicator to show passing status. (red X — shows no entry; green → shows entry)

Anti-pinch Function: When someone is present, the infrared sensor will detect it and the door will not close, ensuring the protection of the individual.

Wireless remote-control function: The front desk can easily open and close the door using the remote control, providing great convenience.

Features

- Support integrated with any type of access control systems.
- Passage width can be extended to 1000mm.
- Lower power consumption.
- Low noise, system runs smoothly.
- Green and red LED indicator display passing status.
- Indoor/outdoor use. (shelter)
- Fire safety requirements, arms open automatically.
- Easy to install and maintain.
- 3 years warranty support.

Customized Service

- Appearance color can be customized based on installation environment.
- Dimensions can be customized to meet your request.
- Logo can be customized.
- Arm glass width optional.
- Infrared sensor number optional.
- Picture: high resolution and 3D renderings pictures can be customized.

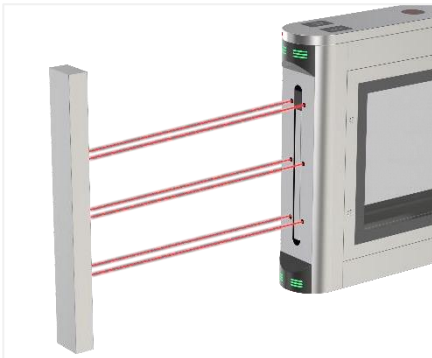

Infrared Sensors (Optional)



Logo Custom



Wide Lane



Anti-pinch Function



LED Light

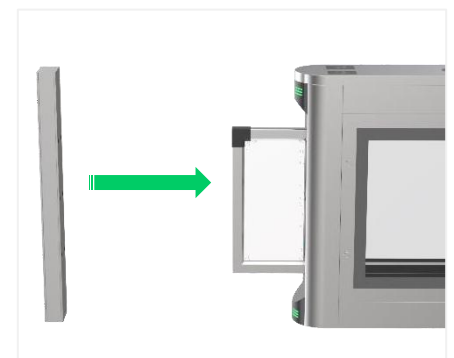

Fire Safety Requirements,
Arms Retract Automatically

Access Control System

Daosafe turnstile gates can be well integrated with any 3rd party access control systems



Button Solution



Card Solution (Optional)



Biometric Solution (Optional)



Remote Control



Touchless Button



Card



QR Code



Fingerprint



Face



Palm Vein

One lane with card solution installed at office building



Specifications

Model No.	DS606
Type	Optical Sliding Turnstile
Brand	Daosafe
Framework Material	304 Stainless Steel + Tempered glass
Tempered Glass	5mm thickness (standard), 8mm thickness (acrylic material optional)
Dimension	1400*270*1100mm
Net Weight	80kg/pcs
Passage Width	1000mm
Passing Direction	Retractable
MCBF	15 million
Power Supply	AC220V/110V, 50/60Hz
Operation Voltage	24V DC
Power Consumption	40W
Operation Temperature	-20 °C - 75 °C
Operation Humidity	0 ~ 95% (No freeze)
Working Environment	Indoor/Outdoor (shelter)
Flow Rate	35 people per minute
LED Indicator	green → entry, red × no entry
Infrared Sensor	3-6 Pairs (Optional)
Emergency	Automatic arm open when power off
Communication	Dry contact, Relay signal, RS485
Flexibility	Integrate with any access control

Dimensions

Front View

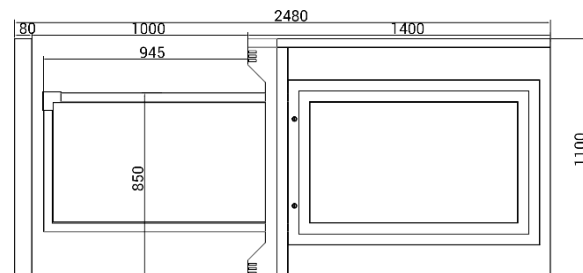

Top View

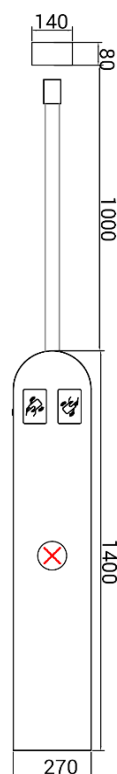

Side View

