



Model DS605

Optical Sliding Turnstile

The main advantage of an optical sliding turnstile is its height coverage. Its enclosure and passageway are completely sealed with glass, covering the entire passage, preventing unauthorized personnel from entering or leaving the area. It is impossible for people to jump over it. This type of door has high security and protection, making it suitable for places that require strict control of access, such as secure areas, prisons, airports, etc.

The LED light bar on the cabinet makes the turnstile more attractive and impressive, easily to catch pedestrian's eyes and enhance the artistry of the sites.

Features

- Two way or one way working.
- Support integrated with any type of access control systems.
- Passage width can be extended to 900mm, the height can be extended to 1800mm.
- Lower power consumption.
- Low noise, system runs smoothly.
- Green and red LED indicator display passing status.
- Indoor use.
- Fire safety requirements, arms open automatically.
- Easy to install and maintain.
- 3 years warranty support.

Customized Service

- Appearance color can be customized based on installation environment.
- Dimensions can be customized to meet your request.
- Logo can be customized.
- Arm glass width and height are optional.
- Infrared sensor number optional.
- Picture: high resolution and scene picture can be customized.

Functions

- **Infrared sensor alarm function:**
in case of illegal intrusion and reverse intrusion.
- **Anti-intrusion function:**
the gate is locked automatically until valid opening signal input.
- **Anti-reverse function:**
the turnstile alarms if someone wants to entry in the reverse direction.
- **Anti-trailing function:**
the sliding gate alarms if someone wants to burst in without permission.
- **Anti-collision and anti-kick function:**
it designed with consolidated and more durable mechanism, will not break even someone collide it.
- **Mechanism self-protection:**
the arm will reset automatically if off position. The movement will not be broken or damaged even hit.



Logo Custom

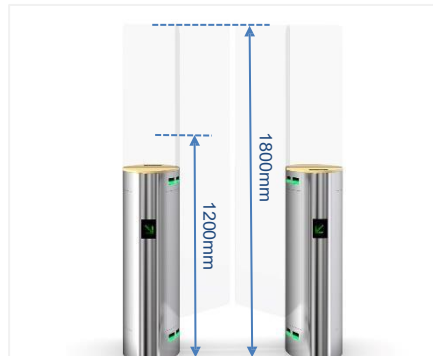

High Glass Optional



Wide Lane Optional



Top Material Optional
(Yellow, Black, 304SS)



Attractive LED Light Bar

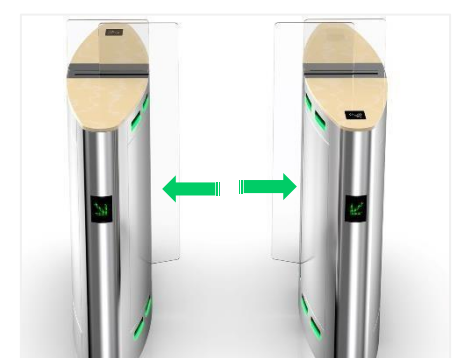

Fire Safety Requirements,
Arms Retract Automatically

Access Control System

Daosafe turnstile gates can be well integrated with any 3rd party access control systems



Card Solution



QR/Bar Code Solution



Biometric Solution



Remote Control



Touchless Button



Card



QR Code



Fingerprint



Face



Palm Vein

Two lanes for card solution installed at university

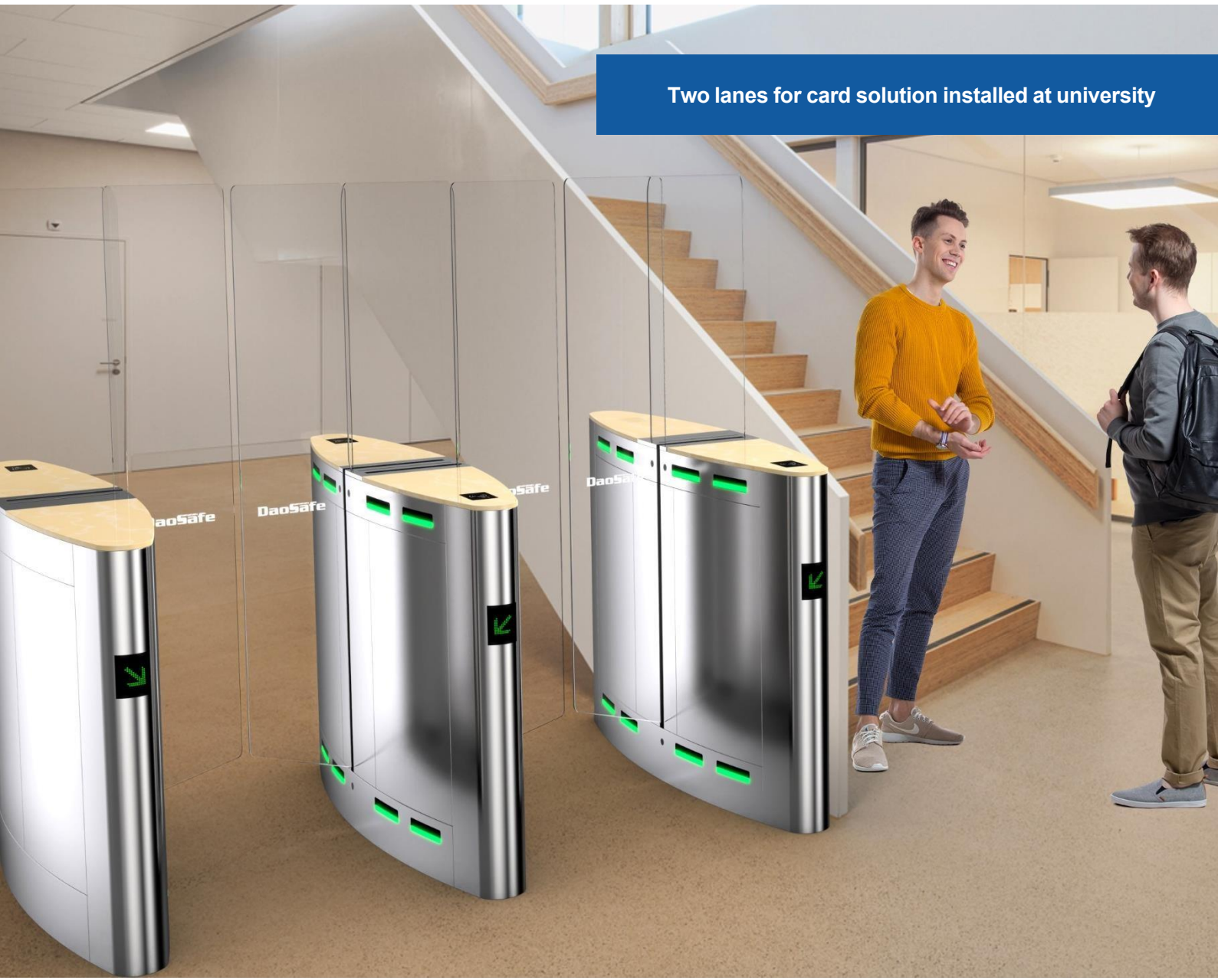

Specifications

Model No.	DS605
Type	Optical Sliding Turnstile
Brand	Daosafe
Framework Material	304 Stainless Steel
Arm material	Plexiglas-transparency
Dimension	1400 * 350 * 1000mm
Net Weight	90kg/pcs (single core), 100kg/pcs (double core)
Passage Width	600mm (standard), 900mm (handicap)
Arm Height	1200mm (standard), 1800mm max. (optional)
Passing Direction	Single directional / Bi-directional
MCBF	15 million
Power Supply	AC220V/110V, 50/60Hz
Operation Voltage	24V DC
Power Consumption	40W
Operation Temperature	-20 °C - 75 °C
Operation Humidity	0 ~ 95% (No freeze)
Working Environment	Indoor / Outdoor (shelter)
Flow Rate	35 people per minute
LED Indicator	green → entry, red × no entry
Infrared Sensor	5 pairs (standard)
Emergency	Automatic arm open when power off
Communication	Dry contact, Relay signal, RS485
Flexibility	Integrate with any access control

Dimensions

Front View

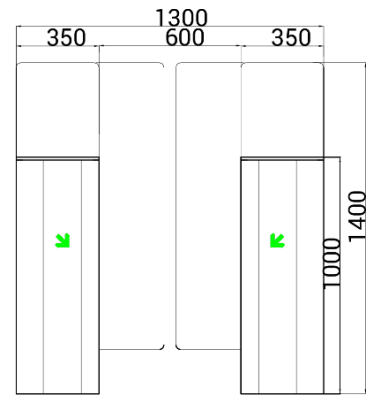

Top View

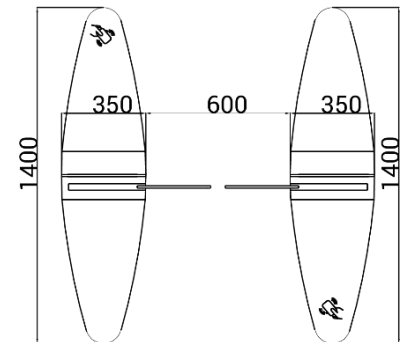

Side View

