



Model DS312

Optical Flap Turnstile

Optical flap turnstile is our most classic wing gate with working mode: retractable in and out, which allows for a faster and more efficient flow of pedestrian traffic in a shorter amount of time.

The body is designed entirely of stainless steel, making the entire structure very sturdy and durable.

Features

- Two way or one way working.
- Support integrated with any type of access control systems.
- 0.1S fast open speed, 45 person/min high throughput.
- Lower power consumption.
- Low noise, system runs smoothly.
- 3 color LED indicator. (Blue, Green, Red)
- IP65 waterproof level, indoor/outdoor use.
- Fire safety requirements, arms retract automatically.
- The card reader window is made of tempered glass, which is very durable and resistant to scratches.
- Easy to install and maintain.
- 3 years warranty support.

Customized Service

- Appearance color can be customized based on installation environment.
- Dimensions can be customized to meet your request.
- Logo can be customized.
- Infrared sensor number optional.
- Picture: high resolution and scene picture can be customized.

Functions

- **Infrared sensor alarm function:**
in case of illegal intrusion and reverse intrusion.
- **Anti-intrusion function:**
the gate is locked automatically until valid opening signal input.
- **Anti-reverse function:**
the turnstile alarms if someone wants to entry in the reverse direction.
- **Anti-trailing function:**
the speed gate alarms if someone wants to burst in without permission.
- **Anti-collision and anti-kick function:**
it designed with consolidated and more durable mechanism, will not break even someone collide it.
- **Mechanism self-protection:**
the arm will reset automatically if off position. The movement will not be broken or damaged even hit.



Logo Custom

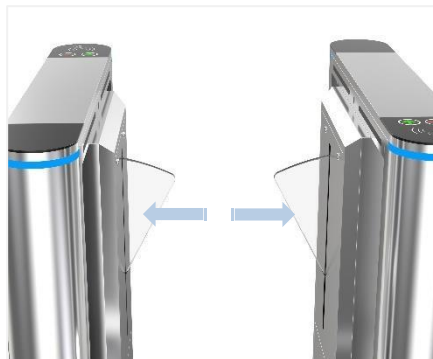

Fire Safety Requirements,
Arms Retract Automatically

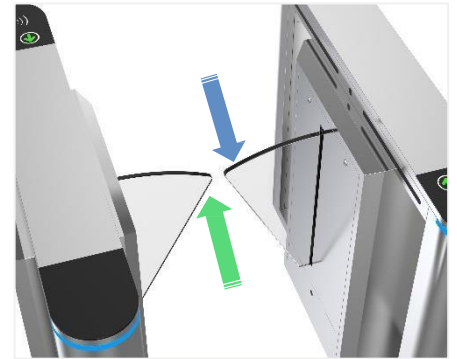

Bi-directional Passage



Sensor Alarm Function



Big Flow Rate: 45 persons per minute

Access Control System

Daosafe turnstile gates can be well integrated with any 3rd party access control systems



Card Solution



QR/Bar Code Solution



Biometric Solution



Remote Control



Touchless Button



Card



QR Code



Fingerprint



Face



Palm Vein

Three lanes for card solution installed at school



Specifications

Model No.	DS312
Type	Optical Flap Turnstile
Brand	Daosafe
Framework Material	304 Stainless steel + plexiglas arm
Arm material	Plexiglas-transparency Blue(optional)
Dimension	1200 * 185 * 1000mm(standard)
Net Weight	60kg/pcs (single core), 80kg/pcs (double core)
Passage Width	600mm
Passing Direction	Single directional / Bi-directional
MCBF	10 million
Power Supply	AC220V/110V, 50/60Hz
Operation Voltage	24V DC
Power Consumption	40W
Operation Temperature	-15 °C - 60 °C
Operation Humidity	0 ~ 95% (No freeze)
Working Environment	Indoor / Outdoor (shelter)
Flow Rate	45 people per minute
LED Indicator	Two LED indicators on top: green → entry, red × no entry
Infrared Sensor	5 pairs (4 pairs up, 1 pair down)
Emergency	Automatic arm open when power off
Communication	Dry contact, Relay signal, RS485
Flexibility	Integrate with any access control



Dimensions

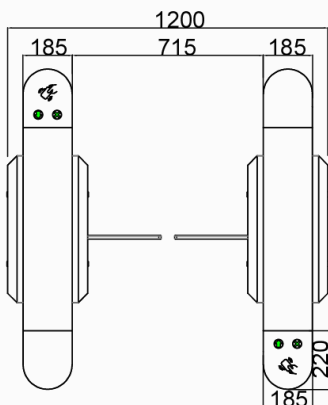

Top View

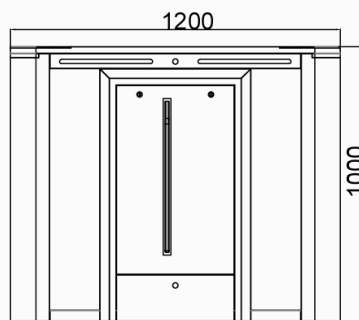

Side View

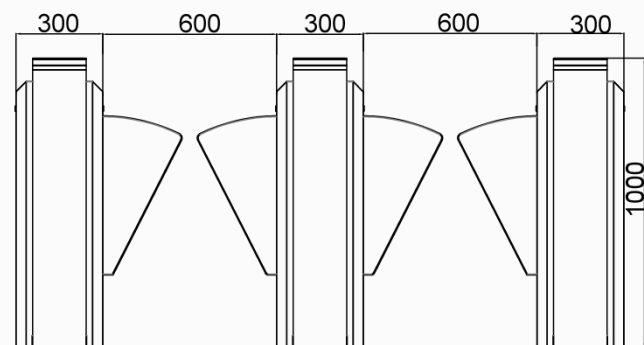

Front View