



## Model DS205A

### Swing Turnstile

One pcs DS205A swing turnstile support 900mm arm, which design for wide passageway, wheelchair, pedestrian with large luggage can pass.

It has only 168mm cabinet, ideal for installation in any narrow place, e.g.: building, dormitory, supermarket, mall, shop etc.

The turnstile's body is robust, rigid, anti-rust, waterproof, and durable.

## Features

- Two way or one way working.
- Passage width can be 900mm.
- Lower power consumption.
- Low noise, system runs smoothly.
- Fire safety requirements, arms open automatically.
- Easy to install and maintain.
- Indoor or outdoor settings with shelter.
- 3 years warranty support.

## Customized Service

- Appearance color can be customized based on installation environment.
- Dimensions can be customized to meet your request.
- Logo can be customized.
- Arm width optional.
- Infrared sensor optional:
  - \*Infrared in front, people no need to swipe card when entry, the door will open automatically when infrared is sensed.
  - \* Infrared in behind, when people exit, the door will automatically open when infrared is sensed.
  - \* Infrared in middle (up or down optional), when adults or children stands in the middle, the anti-pinch function will prevent from being hit.
- Radar optional.
- Picture: high resolution and scene picture can be customized.

0



Logo Custom



Infrared Sensor Optional



Wide Passage



Slim Cabinet



Fire Safety Requirements,  
Arms Open Automatically



• Anti-pinch Function

One pcs for button solution installed at office building



## Specifications

Model No.	DS205A	Operation Voltage	24V DC
Type	Swing Turnstile Gate	Power Consumption	40W
Brand	Daosafe	Operation Temperature	-15 °C - 60 °C
Framework Material	304 Full Stainless Steel	Operation Humidity	0 ~ 95% (No freeze)
Dimension	168 * 1050mm	IP Level	IP54
Net Weight	25kg/pcs	Working Environment	Indoor / Outdoor (shelter)
Passage Width	≤900mm	Flow Rate	40 people per minute
Passing Direction	Single directional / Bi-directional	Infrared Sensor	Optional
MCBF	10 million	Emergency	Automatic arm open when power off
Power Supply	AC220V/110V, 50/60Hz	Communication	Dry contact, Relay signal, RS485

## Optional Models

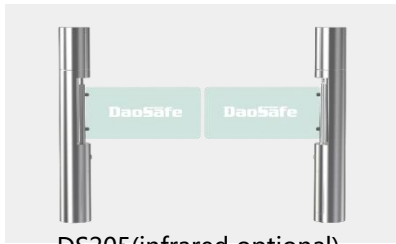

DS205(infrared optional)

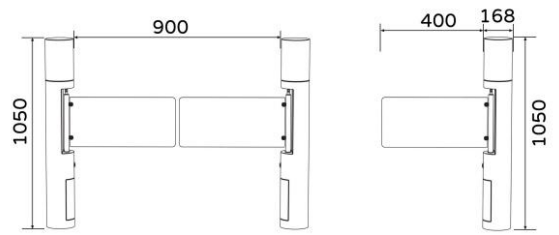

DS205A(infrared optional)

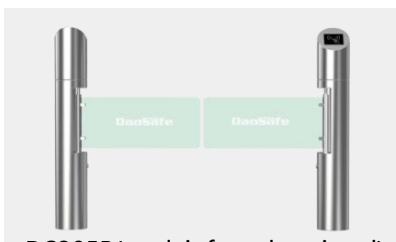
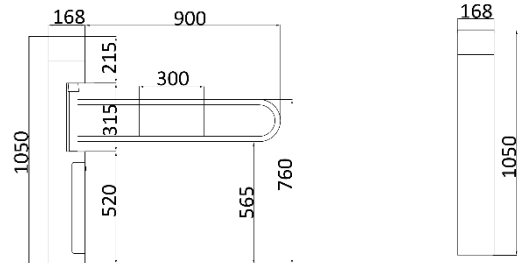

DS205B(card, infrared optional)

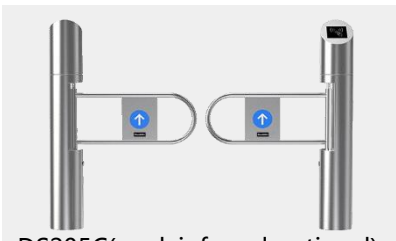
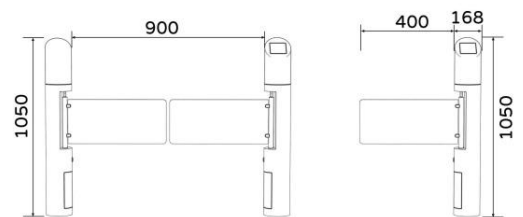

DS205C(card, infrared optional)

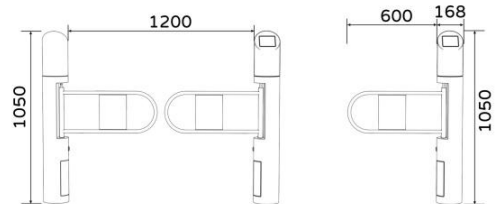

DS205D(card, infrared, with railing)

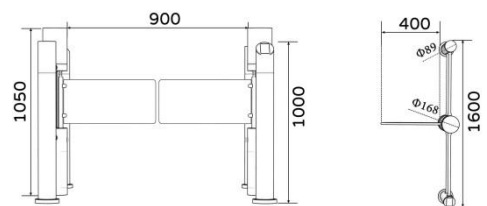

DS205E(card, infrared, with railing)

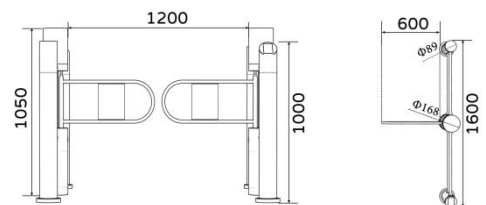

DS205F(QR code, infrared, with railing)

