



Model DS-Q60

Speed Gate

DS-Q60 Quantum speed gate is the fastest open and close speed gate on the market. Its main advantages:

- DS-Q60 short speed gate is tiny and compact designed for small spaces with higher security.
- With 45 persons passing per minute which is perfect for the sites with big visitor's flow rate.
- Support 600mm~1200mm for wide passageway, wheelchair, and pedestrian with large luggage can also pass.
- Support 900~1800mm max. glass height which is perfect for the places where need high security requirement.
- Design with classic black, elegant and timeless pairing, perfect for using at high end applications.

Features

Functions

Customized Service

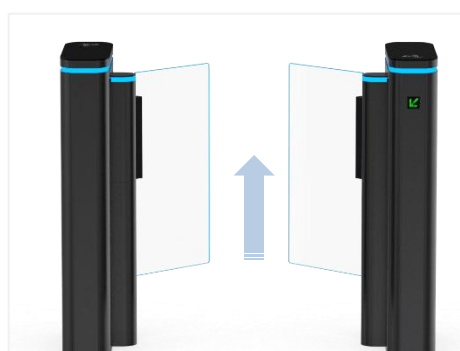
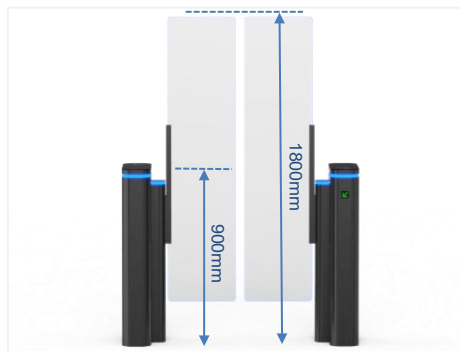

Access Control System

Daosafe turnstile gates can be well integrated with any 3rd party access control systems



Two lanes for card solution installed at building



Specifications

Type	Quantum Speed Gate
Framework Material	Steel + white and black powder coated Tempered glass
Dimension	450(L) * 160(W) * 978(H)mm
Passage Width	<ul style="list-style-type: none">• 600mm (standard)~1200mm (Maximum)• 900mm (recommended disabled lane)• Wider width increases arm size and motor load.
Passing Direction	Single directional/Bi-directional
Power Supply	AC220V/110V, 50/60Hz
Power Consumption	40W
Operation Humidity	0 ~ 95% (No freeze)
Working Environment	Indoor/Outdoor (can be customized)
LED Indicators (Strips)	Blue color: power on, green color: entry, red color: no entry
Infrared Sensor	7 pairs (standard)
Card Reader Mount	Under the top of the cabinet Max. dimensions: 100(L) * 60(W) * 25(T)mm (can be customized)
Emergency	Automatic arm open when power off
Communication	Dry contact, Relay signal, RS485
Flexibility	Integrate with any access control

Dimensions

Parameter	Standard	Recommended (disabled)	Maximum	Note
Passage Width	600mm	900mm	1200mm	Wider width increases arm size and motor load
Arm Height	900mm	/	1800mm	For 1800mm H and 1200mm W, use hollow glass arms to reduce wind resistance

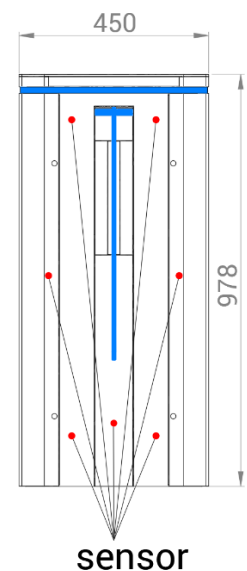
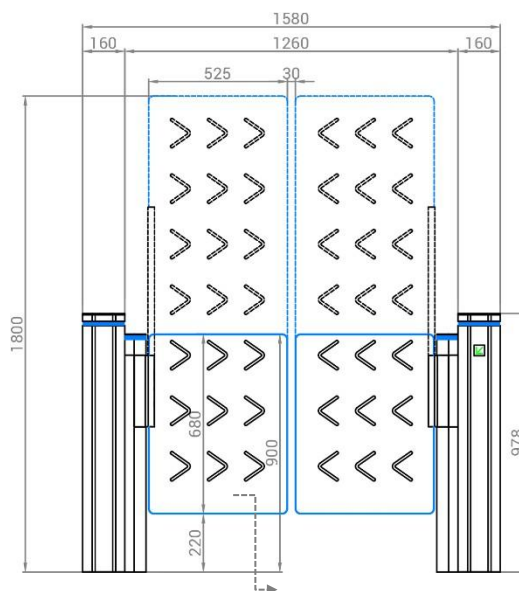
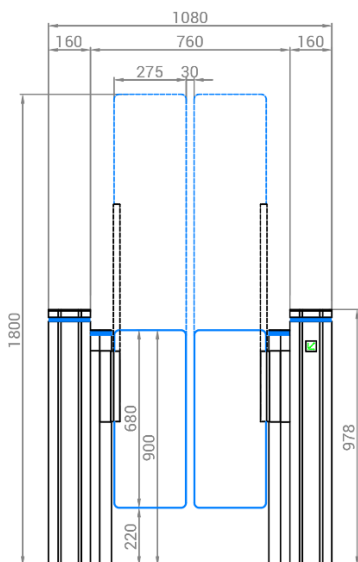
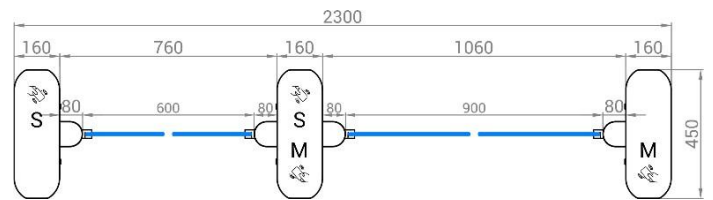
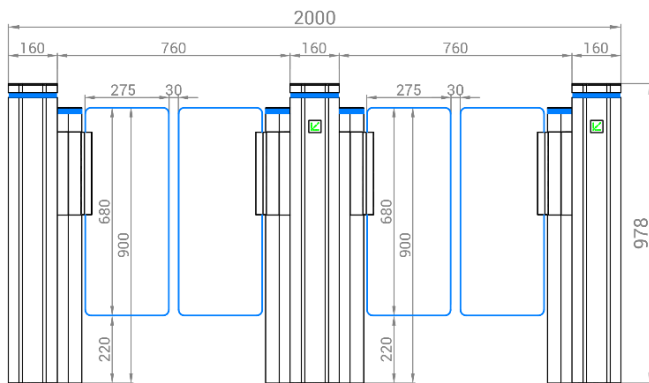
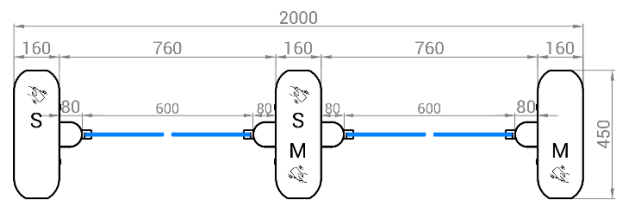
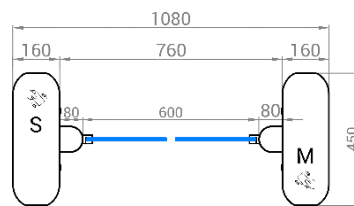
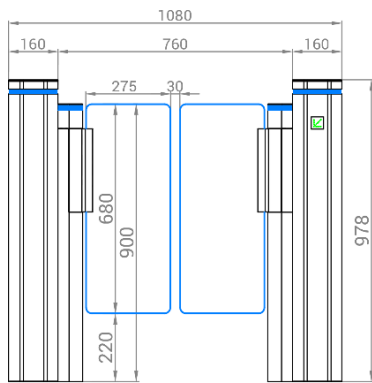

sensor

Lane Solution



Color Customization



High Glass + Disabled Access

